

GN 75

**GENESIS 75**



A three chamber window system for designing windows featuring increased thermal performance. The thermal parameters of Genesis 75 comply with the requirements that will become effective in 2021.

# GN 75

A three chamber window system for designing windows featuring increased thermal performance. The thermal parameters of Genesis 75 comply with the requirements that will become effective in 2021 ( $U_w$  exceeding 0.90).

The Genesis 75 system is based on 75 mm deep sections use to build frames.

Genesis 75 is a system intended for designing window structures in public access buildings as well as single-family and multi-unit residential buildings.

A wide range of sections/profiles available in the offer of the Genesis 75 system is used to design modern windows, doors and display units that ensure high functionality.

The Genesis 75 system incorporates modern insulation materials that have just been launched onto the market. Apart from a conventional central gasket, an additional thermal gasket has been developed as well. With this solution, it is possible to attain very excellent tightness of windows (air infiltration, water-tightness) as well as innovative appearance and aesthetics.

The system will allow the customer to select various finish options for profiles so that the window structure can be customised.

The Genesis 75 window system sets a new standard of window thermal performance, with the highest ergonomics of use and modern profile aesthetics maintained.

There is possibility of use Flyscreen system (Flyscreen – fly screens are a practical and an extremely functional protection against insects).

A wide range of colours available - RAL palette, structural colours, Aliplast Wood Colour Effect, bi-colour and anodized finish.

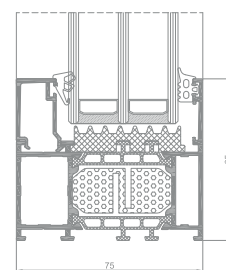

cross-section of the G75 window  
(GN 011)

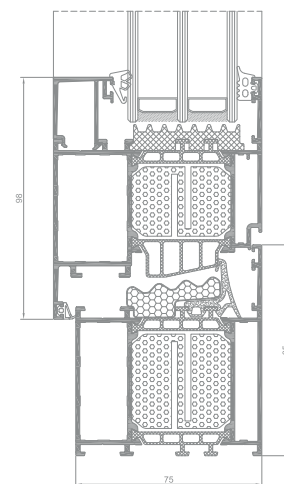

cross-section of the G75 window  
(GN 013 + GN 022)



(GN 011)

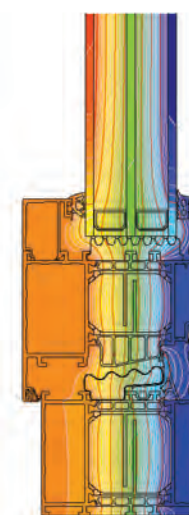

(GN 013 + GN 022)

example distribution of isotherms for the combination  
of a frame with a GN 75 system window sash

## TECHNICAL SPECIFICATION

SYSTEM	MATERIAL	DEPTH OF FRAME	DEPTH OF LEAF	GLAZING RANGE	TYPE OF WINDOWS	TYPE OF DOORS
GN 75	aluminium / polyamid	75 mm	84 mm	fix 1 - 56 mm window 9 - 65 mm	fix, tilt, turn, tilt and turn	—

## PERFORMANCE

SYSTEM	THERMAL INSULATION $U_f$ *	AIR PERMEABILITY	WINDLOAD RESISTANCE	WATERTIGHTNESS
GN 75	$U_f$ from 0,84 W/m <sup>2</sup> K	Class 4; EN 12210	C4 (1600 Pa); EN 12210	E1500/E1950* (1950 Pa); EN 12208

\* Thermal performance depends on the combination of profiles and infill thickness.

\* A value of 1950 Pa was obtained during testing.